



Lifellink (Ethernet to Serial)  
Wired

## Take Control with Lifellink®

Lifellink® is the world's first conversion module that allows you to turn home systems into Web Services-enabled devices, making the devices easily discovered and controlled by Life|ware® home control software.

It's the smart, easy way to convert systems, like security alarms, and devices, like lights and dimmers, into components you can control over a network.

Lifellink also makes installation and setup simpler by dynamically discovering and configuring existing Web Services-enabled devices.

Available as an external plug-in, an embedded package, or as software that can be integrated into a supported vendor's home control hardware, Lifellink lets you get more out of home automation.

### Features

- Available as an external plug-in, embedded package, or software
- Wired and wireless connections available
- Ethernet to Serial or Ethernet to Relay Triggers
- Reduces wiring in the home and frees up connections to your Media Server

### Models

Model	Type	Connection
LLS-100	Ethernet to Serial	Wired and Wireless
LLR-100	Ethernet to Relay Triggers	Wired
LLR-150	Ethernet to Relay Triggers	Wireless

*Information on embedded packages or software available on request.*

Lifellink (Ethernet to Serial)  
Wired and Wireless



Lifellink  
(Ethernet to Relay Triggers)  
Wired



Lifellink  
(Ethernet to Relay Triggers)  
Wireless





## Weight

**Ethernet to Serial or Ethernet to IR (Wired and Wireless)** – Approx. 0.5 lbs.

**Ethernet to Relay Triggers** – Approx. 1 lbs.

## Connections

**Power** – 5.5V DC 750mA power supply

**LAN** – 10/100 Base-T (RJ-45 jack) (wired version only) Cat5e cable

**Serial** – DB9 for Serial RS232

**Wireless** – 4" Dipole 802.11b antenna

## Warranty

**Parts** – 1 year

**Labor** – 90 days

Effective from date of shipment to the dealer

All models include wall mount bracket.

## Dimensions:

### Life|link (Ethernet to Serial/IR)

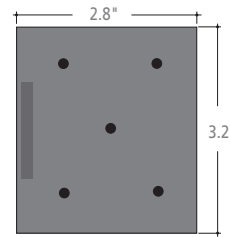

Bottom View

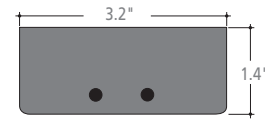

Side View

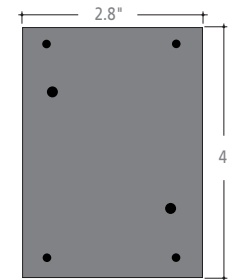

Mounting Plate

### Life|link (Ethernet to Relay Triggers)

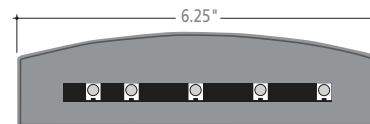

Front View



Side View

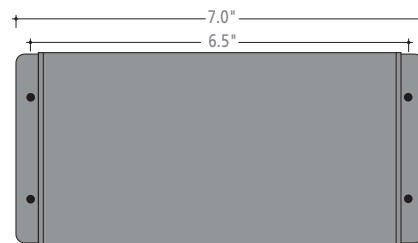

Bottom View with Mounting Plate